



EV-12V-010V-60D



### 12V DC 60W Dimmable 0-10V LED Driver ETL (UL) approved

- 60W 12V Class 2 Driver, Dimmable from 0/1-10V/Potentiometer/10V (3 in 1) dimmer.
- Input Voltage range from 100~130V AC, 47-63Hz, PF > 0.9
- Dimmable DC Output: 12V, 60W
- Protection: Short-Circuit / Over Current / Over Temperature and Auto-recovery Mode
- IP67 Indoor or outdoor operation, Cooling by free air convection -20C to +45C, full load, max case 60C, 20 to 95% RH NC
- Input Wire Connection: ( N, L, Earth), Output Wire connection: +V, GND
- Approvals: ETL (**UL**), CE, FCC, RoHS
- Size: 7.87" L x 2.70" W x 1.77" H, (200 x 68.5 x 45mm)
- 2 year warranty
- Note: Dimming performance optimal at greater than 50% load
- Note: Best Dimmers Leviton Decora DS710-10Z, Lutron Diva DVSTV-WH





Specification:

Model		EV-12V-60D	EV-24V-60D
Certificates		ETL, CE, FCC	ETL, CE, FCC
output	DC Voltage	12V	24V
	Voltage Tolerance	±0.5V	
	Rated current	5A	2.5A
	Rated power	60W	
input	Voltage Range	100~130VAC	
	Frequency Range	47~63HZ	
	Power Factor (Typ.)	PF≥0.9	
	Efficiency (Typ.)	>88%	>88%
	AC Current (Typ.)	1.5A	
	Leakage current	< 0.66mA @120VAC	
Protection	Short Circuit	Hiccup mode, recovers automatically after fault condition is removed	
	Over Voltage	280VAC	
	Over temperature	100c±10% (The output voltage will turn off when the temperature reaches this max, then after the temperature drops off ,it will recovery automatically)	
Environment	Working TEMP.	-40~+60c	
	Working Humidity	20~90%RH, non-condensing	
	Storage TEMP. Humidity	-40~+80c, 10~95%RH	
	TEMP .coefficient	±0.03%/c (0~50c)	
	Vibration	10~500Hz, 2G 10min./1 cycle, period for 60min. each along X,Y,Z axes	
Safety& EMC	Safety standards	UL1012	
	Withstand voltage	I/P-O/P:1500VAC	
	Isolation resistance	I/P-O/P : 100MΩ/500VDC/25°C/70%RH	
	EMC EMISSION	FCC Part 15 B	
others	Net. Weight	1.1Kg	
	Size	200 x 68.5 x 45 (L*W*H)	
	packing	329*279*176mm	10PCS/CTN
Notes	1) All parameters if NOT specially mentioned are measured at 110VAC input, rated load and 25c ambient temperature. 2) To extend the driver's life, please reduce the loading at lower input voltage. 3) Loading should be 5-100%.		



### Dimming Operation

- Blue is DIM+, White is DIM-
- Built-in 3 in 1 dimming function, IP66 rated .Output constant current level can be adjusted through output cable by connection a resistance or 0/1-10V DC or 10V PWM signal between DIM+ and DIM-
- Reference resistance value for output current adjustment (Typical)

Resistance value	Single driver	0Ω	10KΩ	20KΩ	30KΩ	40KΩ	50KΩ	60KΩ	70KΩ	80KΩ	90KΩ	100KΩ	OPEN
	Multiple drivers	0Ω /N	10KΩ /N	20KΩ /N	30KΩ /N	40KΩ /N	50KΩ /N	60KΩ /N	70KΩ /N	80KΩ /N	90KΩ /N	100KΩ /N	--
Percentage of rated current		0%	10%	20%	30%	40%	50%	60%	70%	80%	90%	100%	102%-108%

### ※1-10/0-10V dimmable function for output current adjustment (Typical)

Dimming value	0V	1V	2V	3V	4V	5V	6V	7V	8V	9V	10V	OPEN
Percentage of rated current	0%	10%	20%	30%	40%	50%	60%	70%	80%	90%	100%	102%-108%

### ※10V PWM signal for output current adjustment (Typical): Frequency range: 100Hz-3KHZ

Duty value	0%	10%	20%	30%	40%	50%	60%	70%	80%	90%	100%	OPEN
Percentage of rated current	0%	10%	20%	30%	40%	50%	60%	70%	80%	90%	100%	102%-108%

### ■Warning

- Prevent reverse polarity
- Risk of Electric Shock. When used outdoors, install in a waterproof fixture, and install only on a circuit protected by a Class A GFCI;
- Risk of Fire. Installation involves special wiring methods to run wiring through a building structure. Consult a qualified electrician;
- Risk of Electric Shock. Mount the unit at a height greater than 1 foot from the ground surface.



■ Mechanical Specification

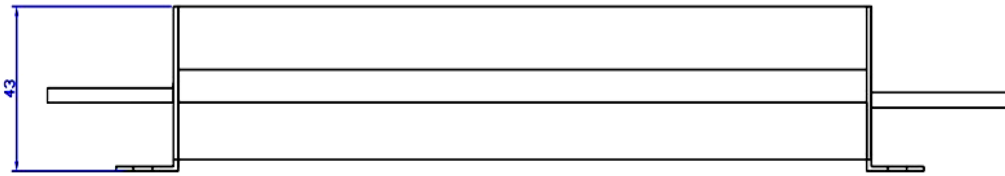
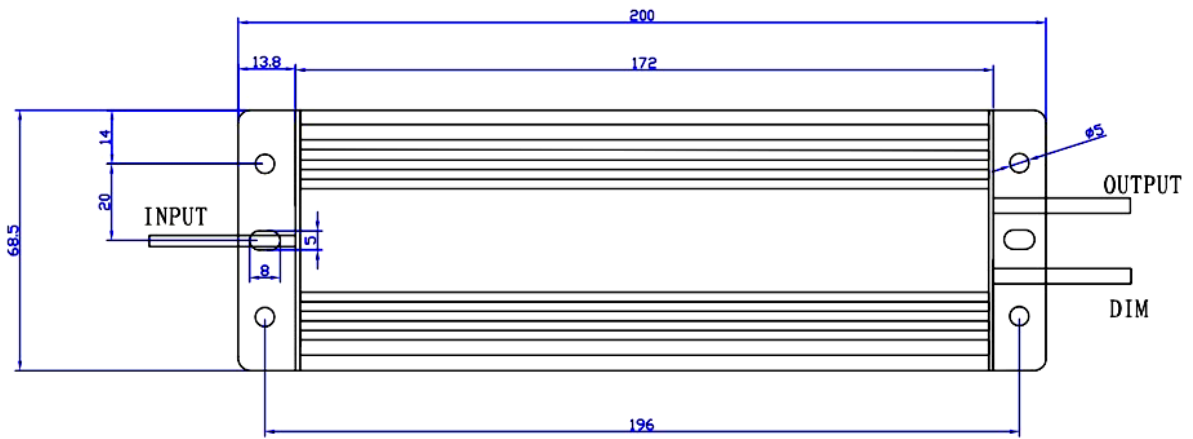

■

## Derating Curve

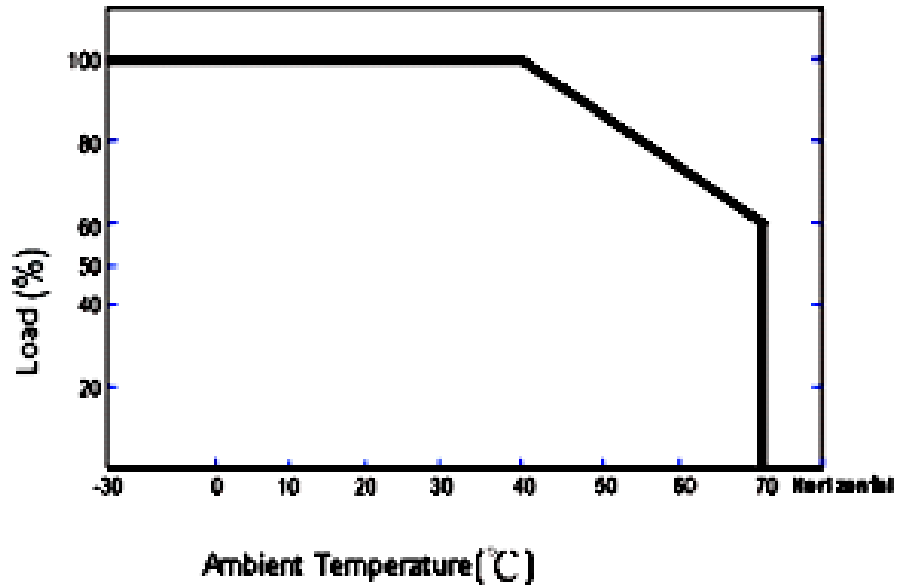

To extend their life, please refer to the Derating Curve and derate according to the temperature

